



Irrigation is localised. Farmers get a very flexible system allowing very easy water management. Pendent systems make very strong installation with very few risks of breaking.

Particularly studied for under tree's foliage irrigation for orchards and citrus fruits. For its conception, the **Djet** is still the most appreciated by users.

nozzle size (mm)	Pressure* (bar)	Discharge* (l/h)	Rayon (Radius)	
			360°	220°
0.8	1.0	18,5	1.2	1.2
	1.5	23	1.5	1.5
	2.0	26	1.7	1.7
1.0	1.0	36	1.6	2.0
	1.5	45	2.1	2.4
	2.0	52	2.4	2.8
1.3	1.0	52	2.1	2.4
	1.5	64	2.5	2.8
	2.0	74	2.8	3.1
1.6	1.0	75	2.2	3.0
	1.5	91	2.7	3.3
	2.0	105	3.2	3.5

* To be used for informational purpose only.

FEATURES

- √ Plastic body and nozzles.
- √ 3 angle choice.
- √ Nozzle from Ø 0.8 to 1.8 mm
- √ Discharge from 19 to 105 l/h
- √ Working pressure : 1 to 3 bars
- √ Can be fixed on riser or with pendent system.

DEFLECTOR

- 16 slots, angle 360°, green
- 10 slots, angle 220°, black
- 2 slots : form 2 fixed jets opposed to 180°

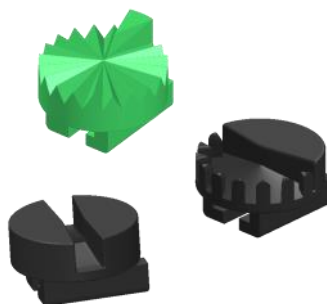

HOW TO FIT**

- DJET16F : Can be fitted on our P4 riser (upright)
- DJET12F : Can be fitted with our pendent system with MMA and TSMA.

